

ATTACHMENT 3

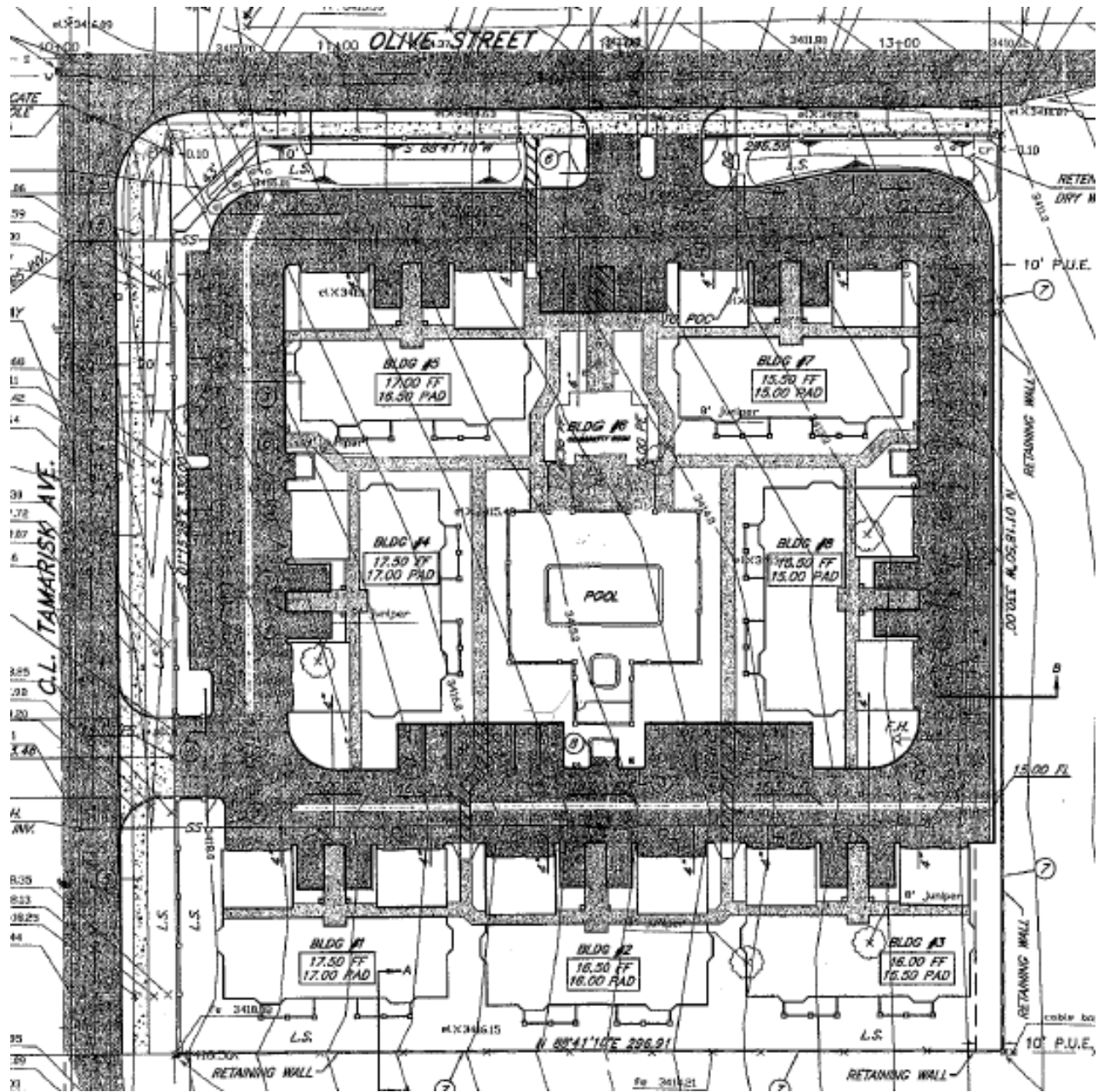

APPLICANT(S):
CITY OF HESPERIA

FILE NO(S): SPLA17-00002

LOCATION:
GENERALLY BOUNDED BY MAPLE AVENUE TO THE EAST, TAMARISK AVENUE TO THE WEST, AND YUCCA STREET TO THE NORTH

APN(S):
3057-131-36
THROUGH 57

PROPOSAL:
A SPECIFIC PLAN AMENDMENT FROM THE VERY LOW DENSITY RESIDENTIAL (VLR) TO MEDIUM DENSITY RESIDENTIAL (MDR) ON 49.5 GROSS ACRES



SITE PLAN (28 CONDO UNITS)