

EXHIBIT "D"

NOTE:

PURSUANT TO THE TERMS OF SECTION 3.23 OF THE DEVELOPMENT AGREEMENT, THE DEVELOPER WILL PREPAY TRAFFIC DEVELOPMENT IMPACT FEES AND THE CITY WILL USE THESE FUNDS, IN THEIR DISCRETION, TO BUILD OFF-SITE ROAD IMPROVEMENTS WHICH MAY INCLUDE RANCHERO ROAD AND AVENUE "I". DEVELOPER WILL BE RESPONSIBLE FOR ALL ON-SITE ROADS AS WELL AS THE RE-ALIGNMENT OF OXFORD FOR ACCESS TO RANCHERO MIDDLE SCHOOL AS PART OF THE PHASE 1 IMPROVEMENTS.

LEGEND:

	DOMESTIC WATER LINE
	DOMESTIC WATER PUMP STATION (PS)
	DOMESTIC WATER TANK SITE
	RECYCLED WATER LINE
	TEMPORARY RECYCLED WATER STORAGE POND
	SEWER LINE
	FORCE MAIN
	SEWER LIFT STATION (LS)
	WASTEWATER RECLAMATION PLANT (WWRP)
	STORM DRAIN
	PROPERTY BOUNDARY
	TRACT BOUNDARY
	PARKS
	INFRASTRUCTURE ROAD
	WATER QUALITY BASIN (WQB) OR EXTENDED DETENTION BASIN (EDB)

PHASE 1 CONCURRENCY PLAN EXHIBIT TR. 18955 INFRASTRUCTURE ONLY

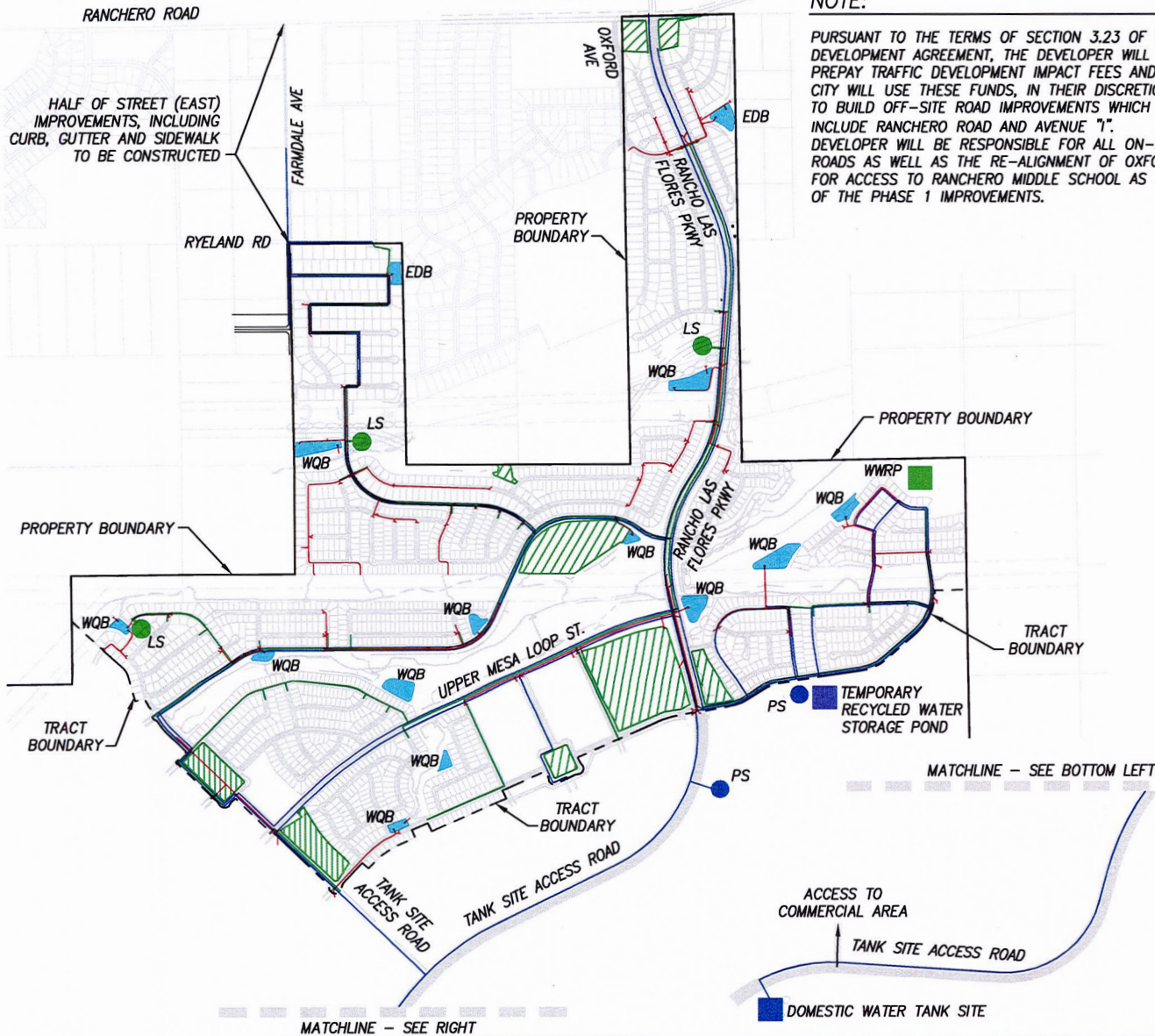
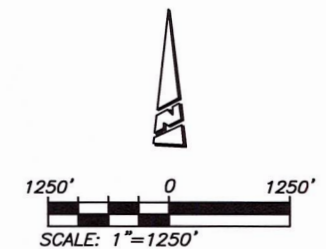

DWG: 18/01/102/000 (Property) (Drawings) (Exhibit) (Concurrency Plan Exhibit) - Phase 1.dwg
 By: A. B. Brown
 Revised: Nov 15, 2017 - 8:22am