

ATTACHMENT 1

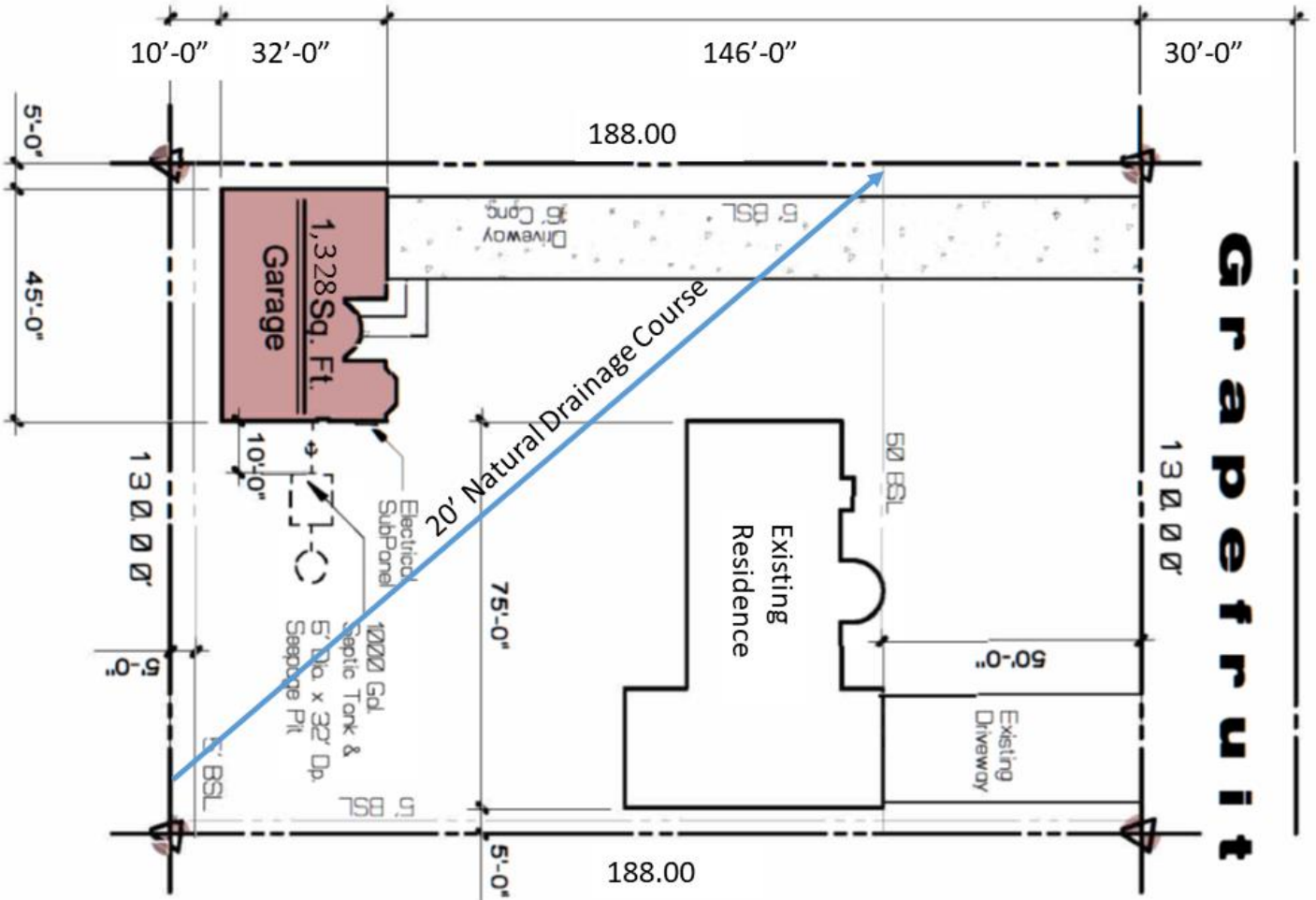

APPLICANT(S): HERACLIO HERRERA	FILE NO(S): VAR19-00003
LOCATION: 8968 GRAPEFRUIT AVENUE	APN(S): 0411-271-18

PROPOSAL: CONSIDERATION OF A VARIANCE TO ALLOW AN ACCESSORY BUILDING (GUEST HOUSE) TO EXCEED THE MAXIMUM HEIGHT OF 16 FEET WHEN LOCATED WITHIN 30 FEET OF A SIDE OR REAR PROPERTY LINE. THE STRUCTURE IS APPROXIMATELY 17.6 FEET IN HEIGHT AND 5 FEET FROM THE SIDE PROPERTY LINE AND 10 FEET FROM THE REAR PROPERTY LINE



SITE PLAN