

ATTACHMENT 1

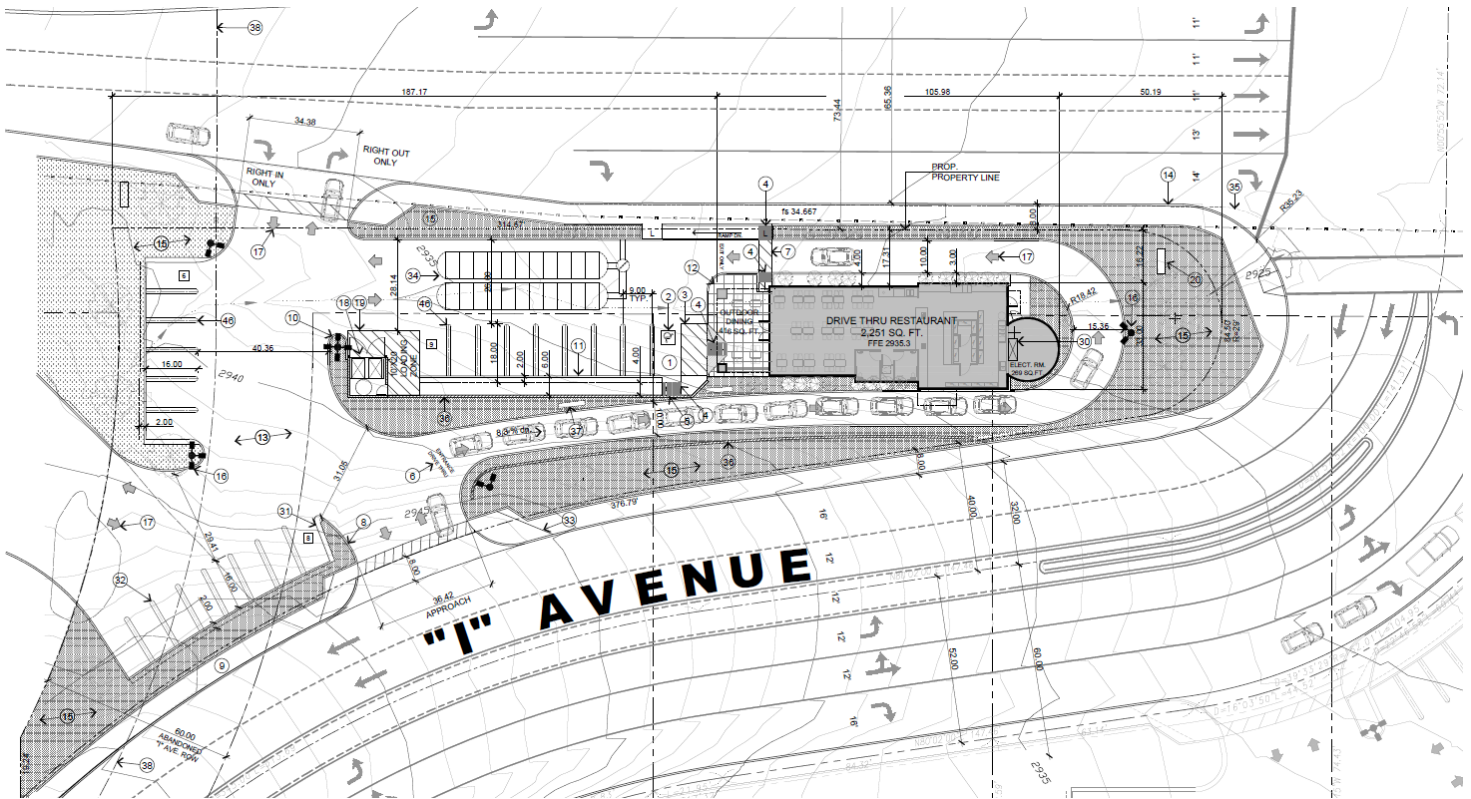

APPLICANT(S): POCHE PARTNERS, LLC

FILE NO(S): SPR19-00011 &
VAR20-00002

LOCATION: SOUTHWEST CORNER OF BEAR VALLEY RD & I AVE

APN(S):
0399-132-01, 04, 28, & 30

PROPOSAL: CONSIDERATION OF SITE PLAN REVIEW SPR19-00011 TO CONSTRUCT A 2,251 SQUARE FOOT DRIVE-THRU RESTAURANT IN CONJUNCTION WITH VARIANCE VAR20-00002 TO ALLOW FOR A REDUCTION IN THE MINIMUM REQUIRED WIDTH OF THE DRIVE-THRU AISLE AS WELL AS A REDUCTION IN LANDSCAPE COVERAGE ON 1.9 GROSS ACRES WITHIN THE SERVICE COMMERCIAL (C3) ZONE



SITE PLAN